

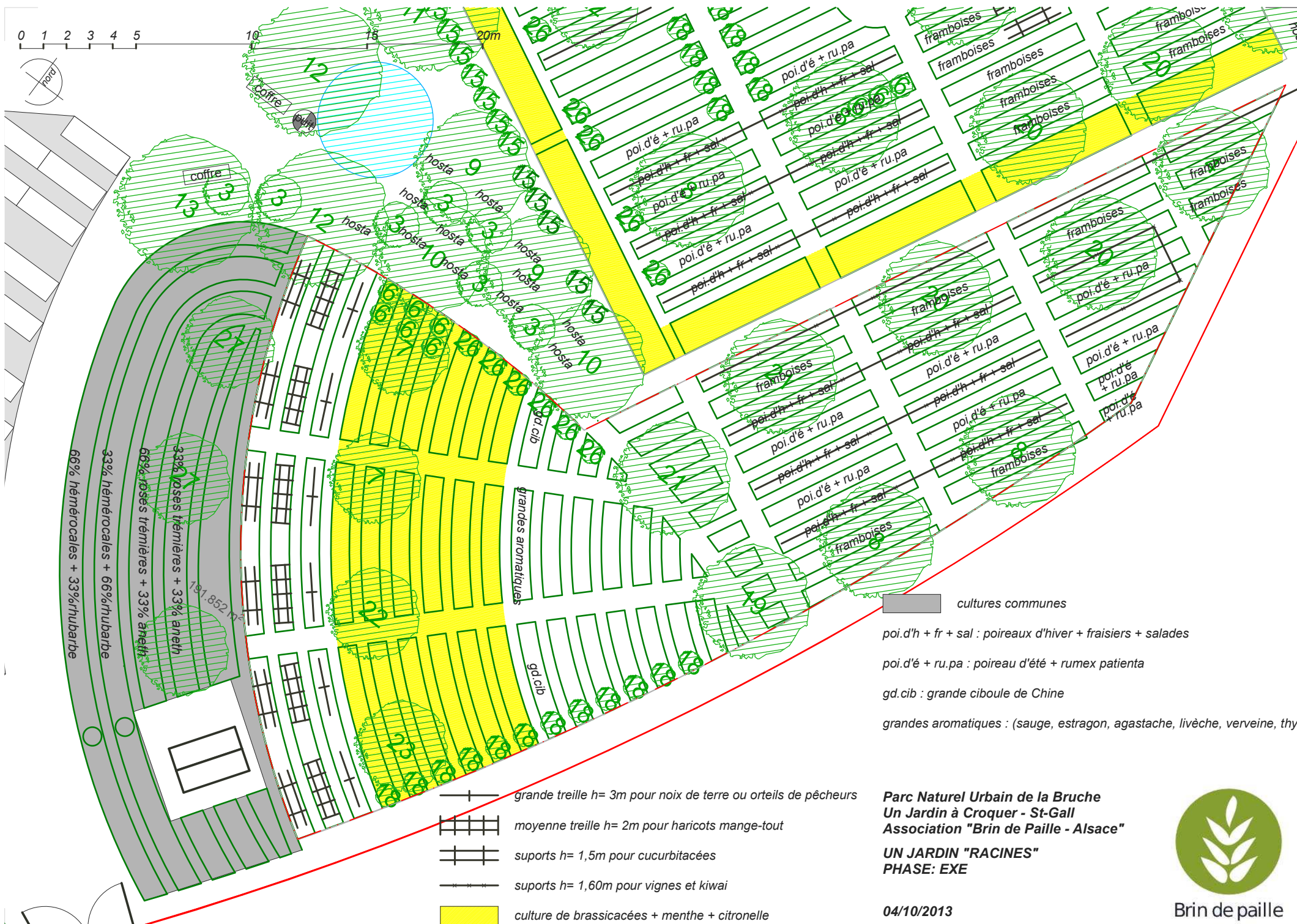





0 1 2 3 4 5



 cultures communes  
 poi.d'h + fr + sal : poireaux d'hiver + fraisiers + salades  
 poi.d'é + ru.pa : poireau d'été + rumex patienta  
 gd.cib : grande ciboule de Chine  
 grandes aromatiques : (sauge, estragon, agastache, livèche, verveine, thyl)

 grande treille h= 3m pour noix de terre ou ortels de pêcheurs  
 moyenne treille h= 2m pour haricots mange-tout  
 supports h= 1,5m pour cucurbitacées  
 supports h= 1,60m pour vignes et kiwai  
 culture de brassicacées + menthe + citronnelle

**Parc Naturel Urbain de la Bruche**  
**Un Jardin à Croquer - St-Gall**  
**Association "Brin de Paille - Alsace"**  
**UN JARDIN "RACINES"**  
**PHASE: EXE**

04/10/2013



Brin de paille